



I36-100/I39-100 Gigabit High Power PoE Injector

Quick Installation Guide

INTRODUCTION

Model	Description
I36-100	60W high power PoE output
I39-100	95W high power PoE output

PACKAGE CONTENTS

* 1x PoE injector	* 1x AC power cord
* 1x Quick Installation Guide	

⚠ IMPORTANT:

1. Use CAT5 or 5e UTP/STP cables.
2. AC input (100~240V/AC, 50~60Hz), for a max. consumption of 65/100W.

CONNECTION

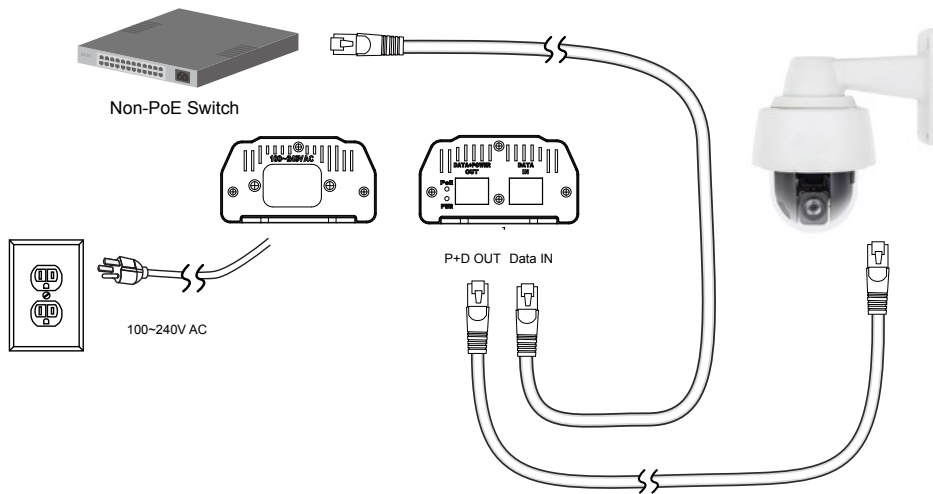

Installation Steps:

1. Connect the included AC power cord to the injector. The Power LED (Yellow) should be lit.
2. Connect the Data IN port to a LAN switch using an Ethernet cable.
3. Connect the Power+Data OUT port to a powered device, i.e., IP camera, using another Ethernet cable. Make sure the PoE LED (Green) is lit.
4. Check if the powered device (IP camera) is working properly. An IP camera may take up to 1 or 2 minutes to power up.

All specifications are subject to change without notice.
Copyright © 2017 AETEK INC. All rights reserved.